

WLC[®]-CAST IRON

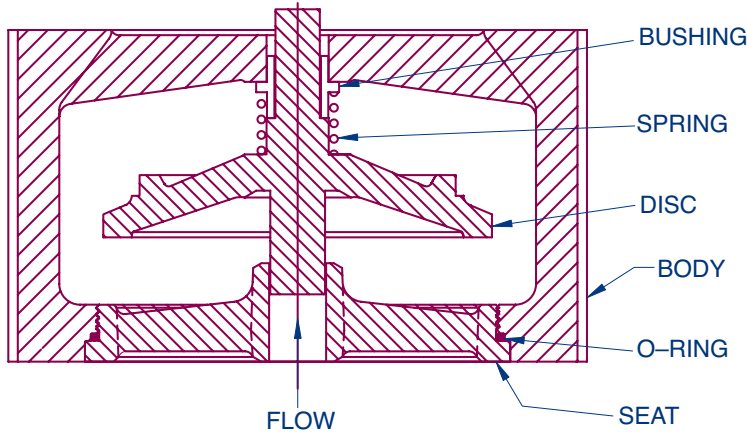

Features:

- Wafer design
- Lightweight
- Spring-assisted silent closing
- Center guided (2" to 10")
- Dual guided stem (2" to 10")
- Horizontal or vertical installation
- Protected spring
- **ASME 125 & 250**
 - 2" to 10" Line Size
 - Cast Iron body⁽¹⁾
 - Bronze or 316 SS trim
 - Ends:
 - Wafer FF
 - AWWA seat leakage
- **OPTIONS:**
 - Buna-N Soft Seat

PRESSURE TEMPERATURE RATING FOR CAST IRON (PSIG)				
Temp. (deg. F)	Class 125		Class 250	
	2 to 12"	14" +	2 to 12"	14" +
0 to 150°	200 psig	150 psig	400 psig	300 psig
200° (MAX.) ⁽²⁾	190 psig	135 psig	370 psig	280 psig

Class 125/250 Cast Iron FF

	2"*	2 1/2"*	3"*	4"*	5"*	6"*
A	2 ⁵ / ₈	2 ⁷ / ₈	3 ¹ / ₈	4	4 ³ / ₄	5 ¹ / ₂
B	4 ¹ / ₄	5	5 ³ / ₄	7	8 ³ / ₈	9 ³ / ₄
Weight	6	7	12	18	27	42
Cv	66	88	130	228	350	520

Class 125 Cast Iron FF

	8"*	10"*
A	6 ¹ / ₂	8 ¹ / ₄
B	13 ³ / ₈	16
Weight	85	129
Cv	900	1450

Class 250 Cast Iron FF

	8"*	10"*
A	6 ¹ / ₂	8 ¹ / ₄
B	13 ³ / ₈	16
Weight	86	137
Cv	900	1450

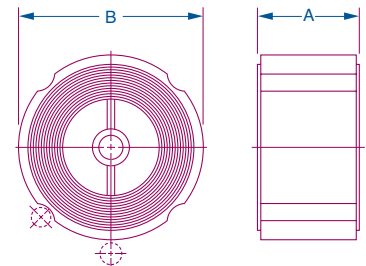

Dual Pressure Service:
Class 125/250 for 2" to 6"

All dimensions are in inches. Weights are in pounds.
*Does not meet API 594 face-to-face dimension.

CAST IRON WLC

COMPONENT	CAST IRON BODY/BRONZE TRIM	CAST IRON BODY/316 TRIM ⁽²⁾
Body	A126 Class B Cast Iron	A126 Class B Cast Iron
Disc/stem assy	B584 836 - Bronze	A351 CF8M
Seat ⁽³⁾	B584 836 - Bronze	A351 CF8M
Spring	A313 T302	A313 T302
Bushing	B584 836 - Bronze	316

Notes: 1. **Not recommended for gas or steam service.**
2. 316 stainless steel trim recommended for temperatures from 180°F to 200°F.
3. Buna-N soft seat available for bubble-tight shutoff.