

# Excalibur<sup>®</sup>

## Features:

- ASME B16.10 Face-to-Face dimensions
- Spring-assisted silent closing, non-slam
- 2" to 24" Line size
- ASME 150 to 1500
- WCB & SS bodies
- SS trim
- Ends:
  - RF Flanged
  - RTJ
- Center guided
- Dual guided stem
- Horizontal or vertical installation
- Tight shut-off
- Two piece body
- Protected spring
- Easy maintenance
- Versatile
- OPTIONS:
  - Soft seat
  - Inconel<sup>®</sup> X-750 Spring
  - Custom sizing - low flow
  - Severe service trim
  - Body Materials:
    - Alloy 20
    - Hastelloy<sup>®</sup>
    - Inconel<sup>®</sup> 600
    - Monel
  - Stellite trim (600°F+)
  - Ends<sup>(1)</sup>:
    - Butt weld
    - Flanged x Butt weld
    - Victaulic<sup>®</sup>
  - NACE (See page 33)
  - API 6D

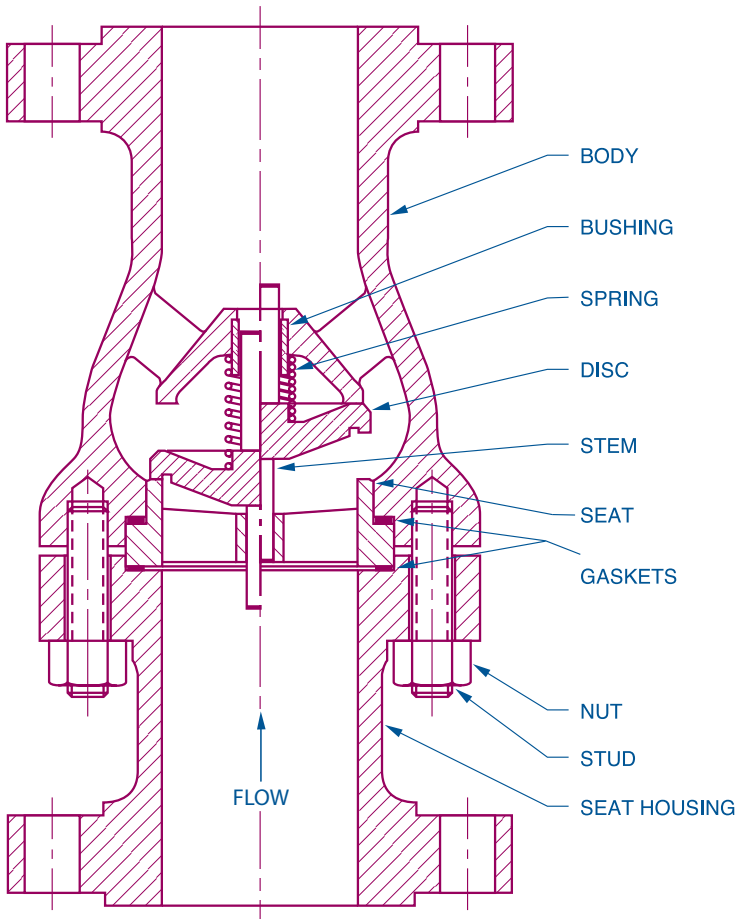

The DFT<sup>®</sup> Excalibur Silent Check Valve is a spring-assisted, center guided, in-line, check valve that provides reliable, low maintenance service for a wide range of fluids and pressure/temperature combinations. The valve consists of a body, gasket, seat, spring, disc with stem and guide bushing. Excalibur check valves are available in a wide range of sizes and pressure ratings and in a variety of metals to meet most check valve requirements.

(1) Consult DFT for availability

Consult pages 34 and 35 for Pressure/Temperature ratings and soft seat materials.

# Excalibur®

## Class 150 RF\*

	2"	2½"	3"	4"	6"	8"	10"	12"	14"	16"	24"
A	8	8½	9½	11½	14	19½	24½	27½	31	34	51
B	6	7	7½	9	11	13½	16	19	21	23½	32
Weight	22	30	37	64	114	207	317	457	642	830	1851
Cv	65	105	155	265	685	1050	1650	2400	3600	5200	11300
CP	0.64	0.44	0.26	0.60	0.40	0.58	0.52	0.53	0.28	0.51	0.42

## Class 300 RF\*

	2"	2½"	3"	4"	6"	8"	10"	12"	14"	20"
A	10½	11½	12½	14	17½	21	24½	28	33	40
B	6½	7½	8¼	10	12½	15	17½	20½	23	30½
Weight	29	42	52	92	177	285	456	696	725	2375
Cv	65	105	155	265	685	1050	1650	2400	3600	7850
CP	0.64	0.37	0.26	0.41	0.40	0.60	0.52	0.53	0.28	0.50

## Class 600 RF\*

	2"	3"	4"	6"	8"	10"	12"
A	11½	14	17	22	26	31	33
B	6½	8¼	10¾	14	16½	20	22
Weight	35	69	138	300	481	981	1320
Cv	65	155	265	584	985	1650	2400
CP	0.64	0.26	0.51	0.73	0.67	0.47	0.50

## Class 900 RF\*

	2"	3"	4"	6"	8"	10"
A	14½	15	18	24	29	33
B	8½	9½	11½	15	18½	21½
Weight	81	155	176	780	1250	1650
Cv	51	138	242	512	777	1449
CP	0.85	0.22	0.58	0.83	0.54	0.58

## Class 1500 RF\*

	2"	3"	4"	6"	8"
A	14½	18½	21½	27¾	32¾
B	8½	10½	12¼	15½	19
Weight	81	158	267	780	1270
Cv	51	109	187	512	777
CP	0.85	0.28	0.74	0.83	0.83

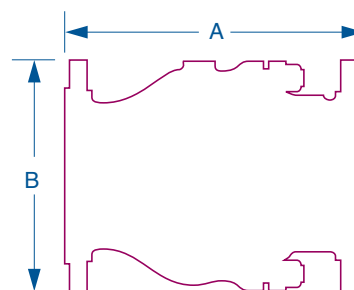

## MATERIALS OF CONSTRUCTION

COMPONENT	CARBON STEEL BODY	STAINLESS STEEL BODY
Body	A216 Grade WCB	A351 CF8M
Disc/stem assy	A351 CF8M/A479 316	A351 CF8M/A479 316
Seat (1)	A351 CF8M	A351 CF8M
Spring (2)	A313 316	A313 316
Bushing	A479 316	A479 316
Bolting (3)	A193-B7 (Stud) & A194-2H (Nut)	
Gasketing (3)	Cl. 150 & 300	CFG (4)
	Cl. 600+	316 Spiral wound with Flexible Graphite Filler

- Notes:
1. Soft seats are available for bubble-tight shutoff. See page 34.
  2. Inconel® 750 spring is available.
  3. Contact DFT for stainless steel or other bolting materials.
  4. 316 graphite material.

\* For other sizes, consult DFT.  
All dimensions are in inches.  
Weights are in pounds.  
CP: Cracking Pressure (psig)