

## Features:

- ANSI B16.10 **Face-to-Face** dimensions
- Spring-assisted silent closing, non-slam
- 1/2" to 3" Line size
- ASME 150 and 300
- Stainless Steel Construction
- Raised Face Flanged ends
- Inconel<sup>®</sup> X-750 spring
- Electron beam welded body
- Meets ASME B16.34 - 2004
- Horizontal or vertical installation
- Body guided disc
- Tight shut-off - lapped disc & seat
- Simplified construction - 3 parts
- Versatile
- **OPTIONS:**
  - 316 SS Springs
  - Body Materials
    - Alloy 20
    - Hastelloy<sup>®</sup> C
    - NACE (Page 33)
    - API 6D

The DFT<sup>®</sup> Model DLC is a corrosion resistant, dependable, versatile and economical spring assisted, in-line check valve for a wide range of applications. Whether the fluid is liquid, gas or steam, the DLC provides tight shut-off and protects other equipment in the system from water hammer. Its stainless steel construction insures a long service life.

## Class 150 RF

	1/2"	3/4"	1"	1 1/2"	2"	3"
A	4.25	4.62	5.00	6.50	8.00	9.50
B	3.50	3.88	4.25	5.00	6.00	7.50
Weight	3.2	4.5	6.0	11.7	19.1	39.2
Cv	7	13	22	54	93	180
CP:Cracking Pressure (psig)	0.29	0.24	0.36	0.24	0.42	0.20

## Class 300 RF

	1/2"	3/4"	1"	1 1/2"	2"	3"
A	6.00	7.00	8.50	9.50	10.50	12.50
B	3.75	4.62	4.88	6.12	6.50	8.25
Weight	4.5	7.2	9.9	18.5	24.3	50.5
Cv	7	13	22	54	93	180
CP:Cracking Pressure (psig)	0.29	0.24	0.36	0.24	0.23	0.20

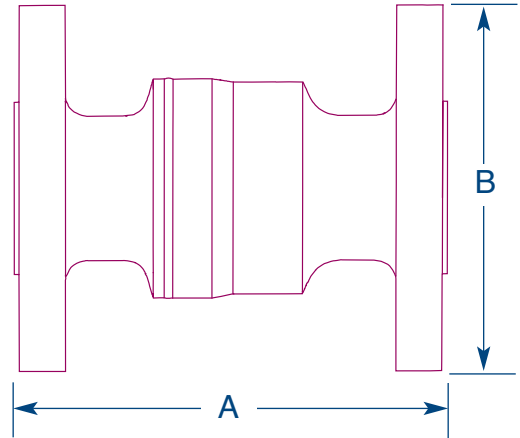

Notes: All dimensions are in inches. Weights are in pounds.

MATERIALS OF CONSTRUCTION	
Body	A351 CF8M
Seat	A351 CF8M
Spring	Inconel® X-750
Disc	316 SS

PRESSURE TEMPERATURE RATING (PSIG) <sup>(1)</sup>							
	A351 CF8M		(CN7M) Alloy 20			Hastelloy C (CW-12MW)	
	ASME	ASME	Temp. (°F)	ASME	ASME	ASME	ASME
Temp. (°F)	150	300	Temp. (°F)	150	300	150	300
-460°	275	720	-325°	230	600	230	600
100	275	720	100	230	600	230	600
200	235	620	200	200	520	210	550
300	215	560	300	180	465	200	520
400	195	515	400	160	420	190	490
500	170	480	500	150	390	170	465
600	140	450	600	140	360	140	440
700	110	435	700			110	420

(1) ASME B16.34-2004