

**Vertical Valve**

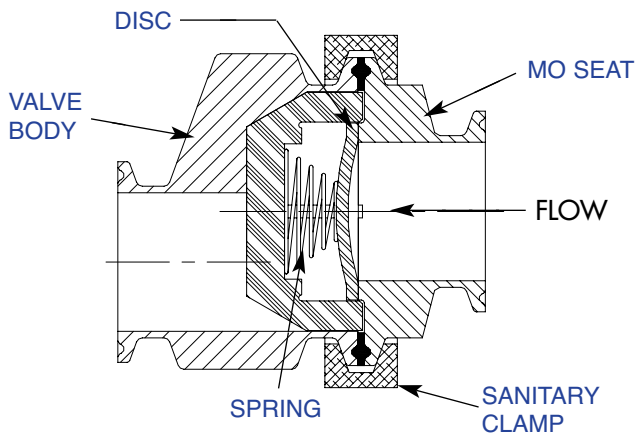

**Horizontal Valve**

## Features:

- Spring-assisted silent closing
- Horizontal or vertical installation
- Sizes  $\frac{1}{2}$ " thru 3"
- 150 CWP, 108 ANSI Pressure Class
- 316L body and seat
- 316 disc, spring and guide assembly
- 25 Ra Internal Surface Finish
- Edge guided disc:  $\frac{1}{2}$ " thru 2"
- Edge/center guided disc: 2-1/2", 3"
- Lapped "metal" seat and disc
- Springs:
  - Low cracking pressures  
.16 psig to .66 psig
  - Conical design
  - Electropolished finish
- Body Seal: EPDM (standard)
- CIP (Clean in Place)
- Clamped ends
- Seat Leakage per MSS SP-61
- 3A Standard
- OPTIONS:
  - 15 Ra Internal Finish
  - Body Seals  
Tuf-Flex  
Viton

The **DSV** is an in-line spring-assisted check valve designed to prevent flow reversal in industries with strict cleanliness codes. To accommodate various piping arrangements, the **DSV** is available as a "**Vertical**" or "**Horizontal**" valve. The Horizontal valve is for Horizontal lines requiring a self-draining valve. The "Vertical" design is for "Vertical" installations and "Horizontal" lines when a self-draining valve is not required. The **DSV**, with a 316L stainless steel body and seat, is fastened with a quick release clamp and elastomeric body seal to permit fast and easy access to the internals. The internal surface finish is **25 Ra** while the disc and seat are lapped to provide excellent shutoff.

## "Vertical" Valve

	1/2"	3/4"	1"	1-1/2"	2"	*2-1/2"	*3"
A	2.50	2.25	2.92	3.29	4.03	5.56	4.38
B (dia.)	.98	.98	2.00	2.50	3.00	4.00	4.00
D (dia.)	.98	.98	1.98	1.98	2.52	3.05	3.58
Weight	1.4	1.3	2.3	2.8	3.9	9.9	6.1
Cv	2.4	7	18	38	53	81	109
CP	Flow Down	.26	.26	.31	.23	.16	.42
	Flow Up	.33	.33	.41	.33	.31	.66

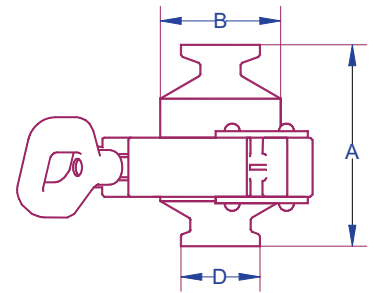

## "Horizontal" Valve

	1/2"	3/4"	1"	1-1/2"	2"	*2-1/2"	*3"
A	2.50	2.50	3.48	3.67	4.41	5.56	4.88
B (dia.)	1.50	1.50	3.00	3.12	3.62	4.75	4.75
D (dia.)	.98	.98	1.98	1.98	2.52	3.05	3.58
Weight	1.4	1.4	3.7	4.0	5.8	11.2	9.9
C	.44	.31	.50	.50	.50	.73	.48
Cv	2.4	7	12	36	47	69	90
CP	.29	.29	.36	.28	.23	.54	.54

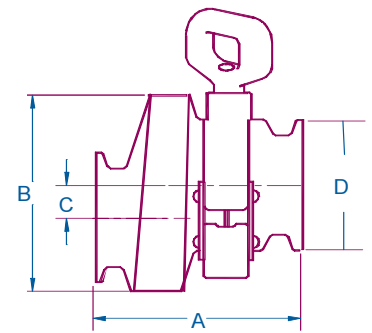

**\* Edge/center guided disc**

All dimensions are in inches. Weights are in pounds.  
CP: Cracking Pressure (psig)

## MATERIALS OF CONSTRUCTION

Body	316L SS
Seat	316L SS
Disc	316 SS
Spring	316 SS (electropolished)
Guide Assembly	316 SS
Body Seal	EPDM** (-75°F to +300°F)
Clamp	304 SS
Internal Surface Finish	25 Ra

\*\* Other body seal materials available upon request

## Pressure Temperature Rating

Temp. ( °F)	PSIG
100	150
200	127
300 <sup>(1)</sup>	118
400 <sup>(2)</sup>	105

(1) Maximum temperature for EPDM

(2) Maximum temperature for Viton & Tuf-Flex